

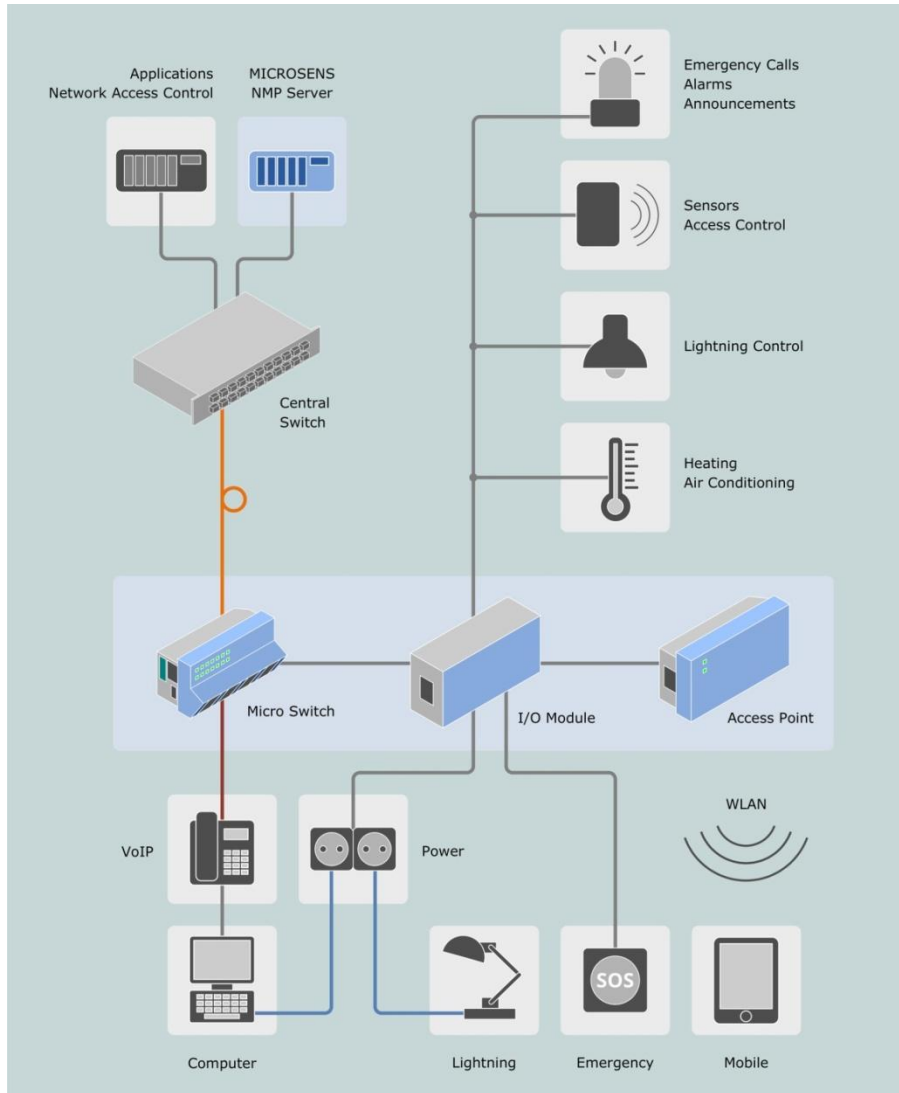

## Intelligent Building Management system





- Because of the intelligent FTTO switch per workplace, a **central intelligence is not necessary anymore**
- For monitoring and central engaging, the network management software can be used based on SNMP3

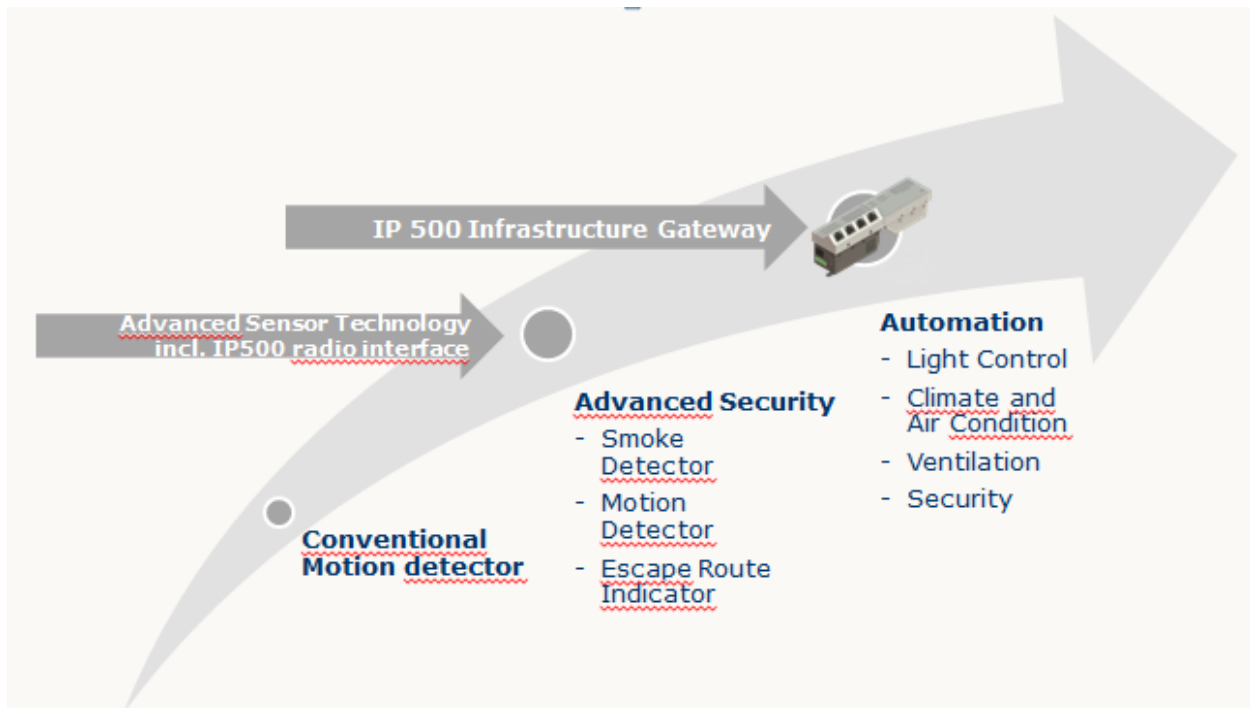

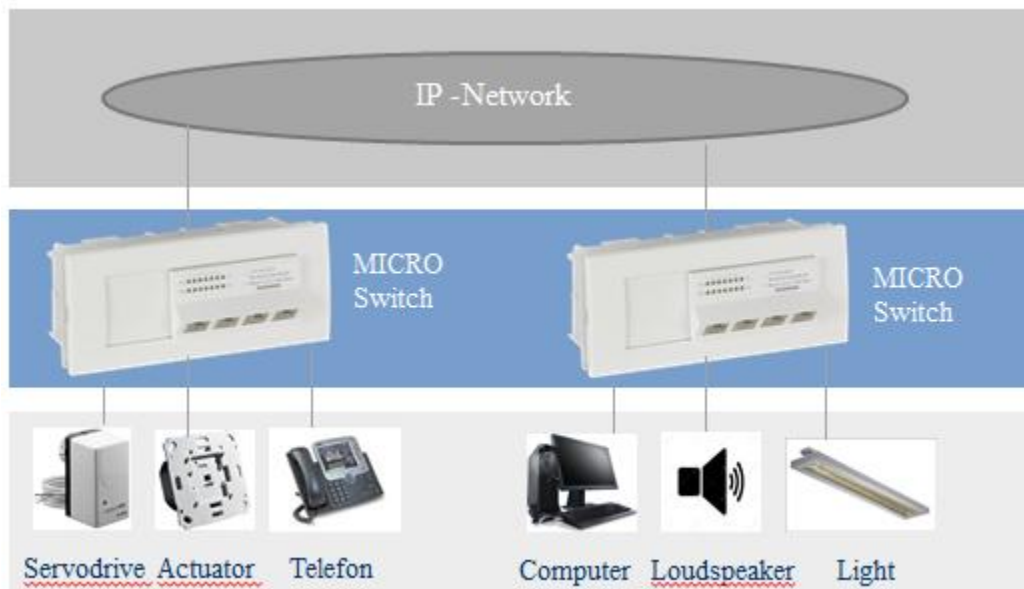
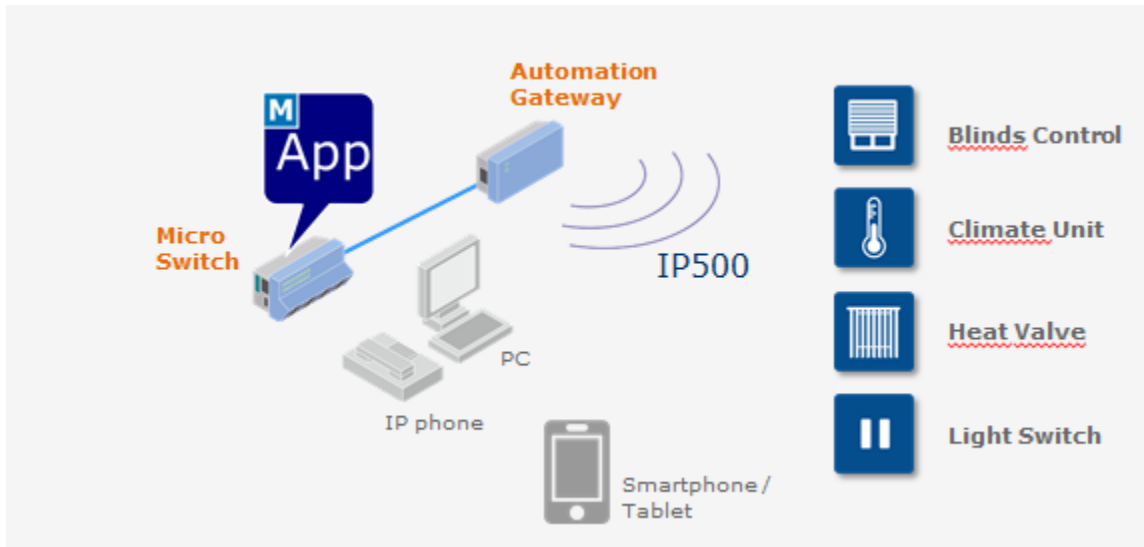

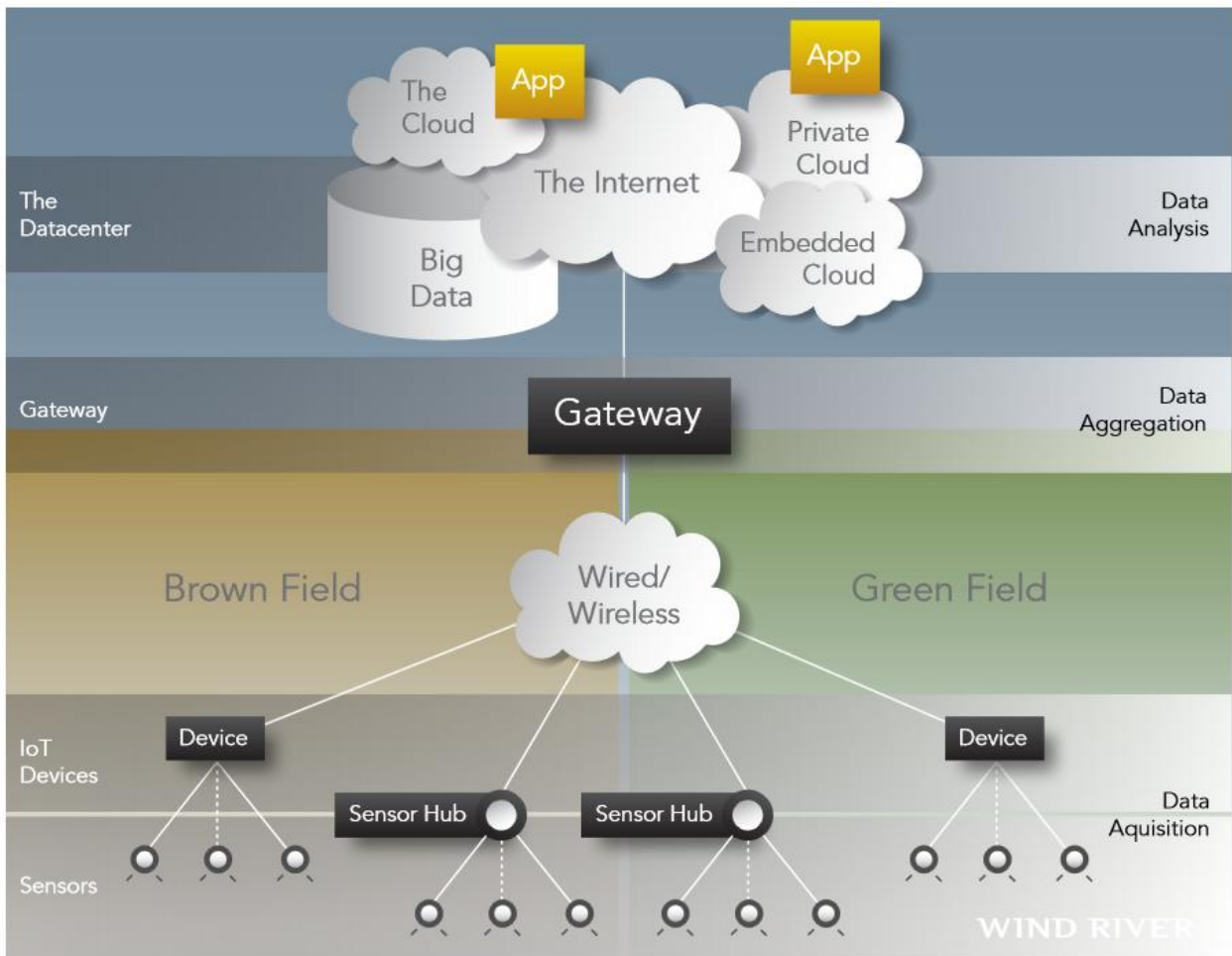
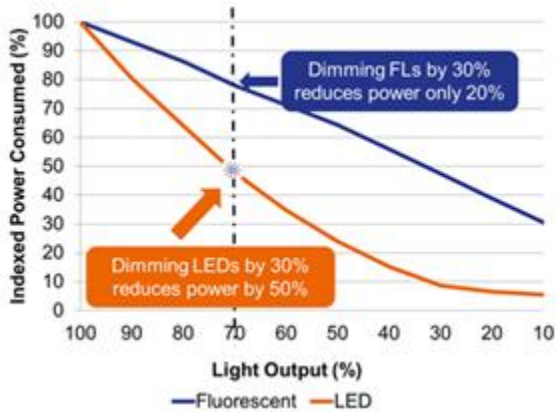



Propagation of sensors and measurement technology into industry, economy, and daily life

Environmental protection and resource conservation

Advancements in the automation of lighting, heating, air conditioning, and ventilation

New infrastructure platforms and services

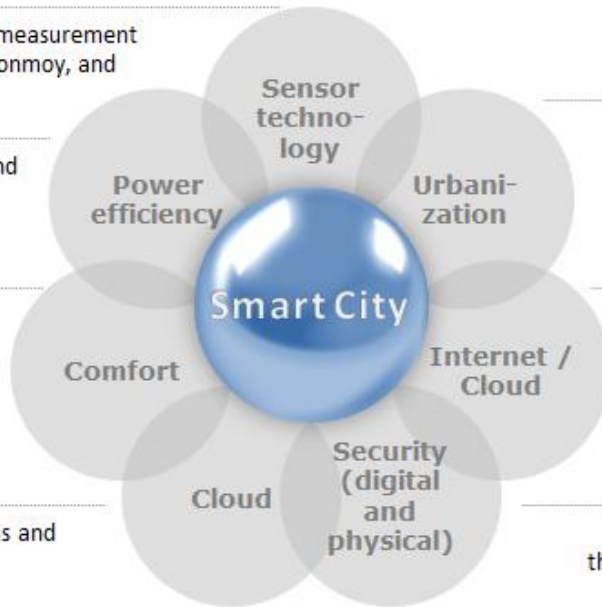

New mobility, work, and drive concepts

Interlinking of things, buildings, persons and machines

Increased need for security through increased risk exposure

*Smart city is a future city model that enhances urban lifestyle, brings systemization of city management resulting in city value enhancement. It is based on digital technology embedded across all city functions and controlled by a central city control center.*

*A smart city uses various technology such as Internet of Things (IoT) that can help address many of the most pressing problems facing towns and cities today, from congestion, pollution, energy use to public safety.*

*Smart City is expected to bring benefits to its stakeholders in economic development – adding value, cutting cost, and generating revenue – besides the enhancement of life quality and maintaining sustainability in environment.*